









Product datasheet

| | |
|-----------------------|--|
| Product name | Internal extractor For extracting inner bearings, bearing outer rings and bushings. |
| Product number | 21-9 |
| Product series | 21 |
| EAN | 4021176011986 |



Technical attributes

| Attribute name | Attribute value |
|--|--|
|  ball bearing ISO | 6014; 6214; 6314; 16014; 6015; 6215; 6315; 16015; 6016; 6216; 6316; 16016; 61816; 6017; 6217; 6317; 6018; 6218; 6318; 16018; 61818; 6219; 6319; 6020; 6220; 6320; 16020; 61820 |
|  inner diameter of ball bearing | 70 - 100 mm (2 3/4 - 3 7/8 inch) |
|  effective depth | 95 mm (3 3/4 inch) |
|  length of internal extractor | 166 mm (6 1/2 inch) |
|  number of segments | 2 |
|  weight | 2.9 kg |

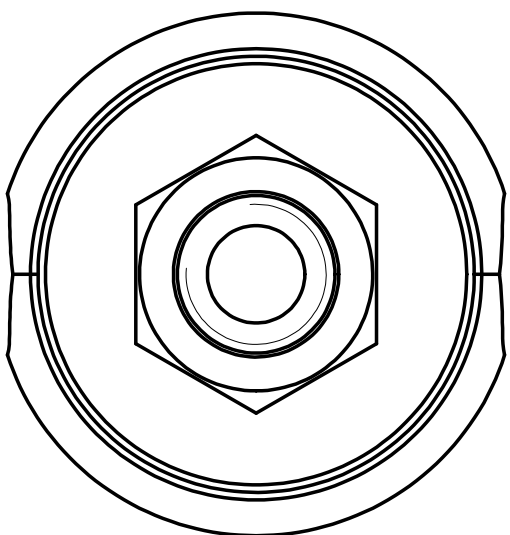
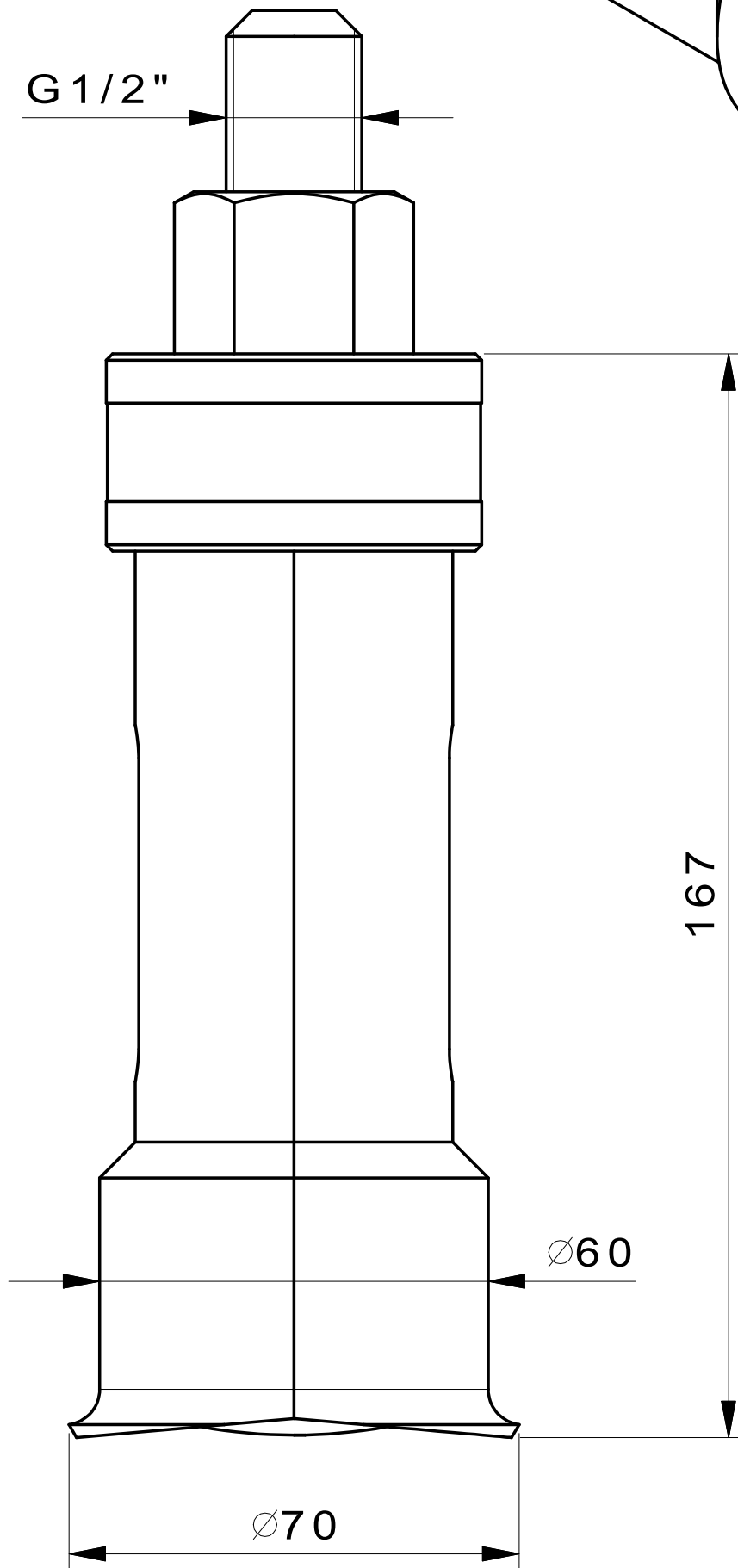
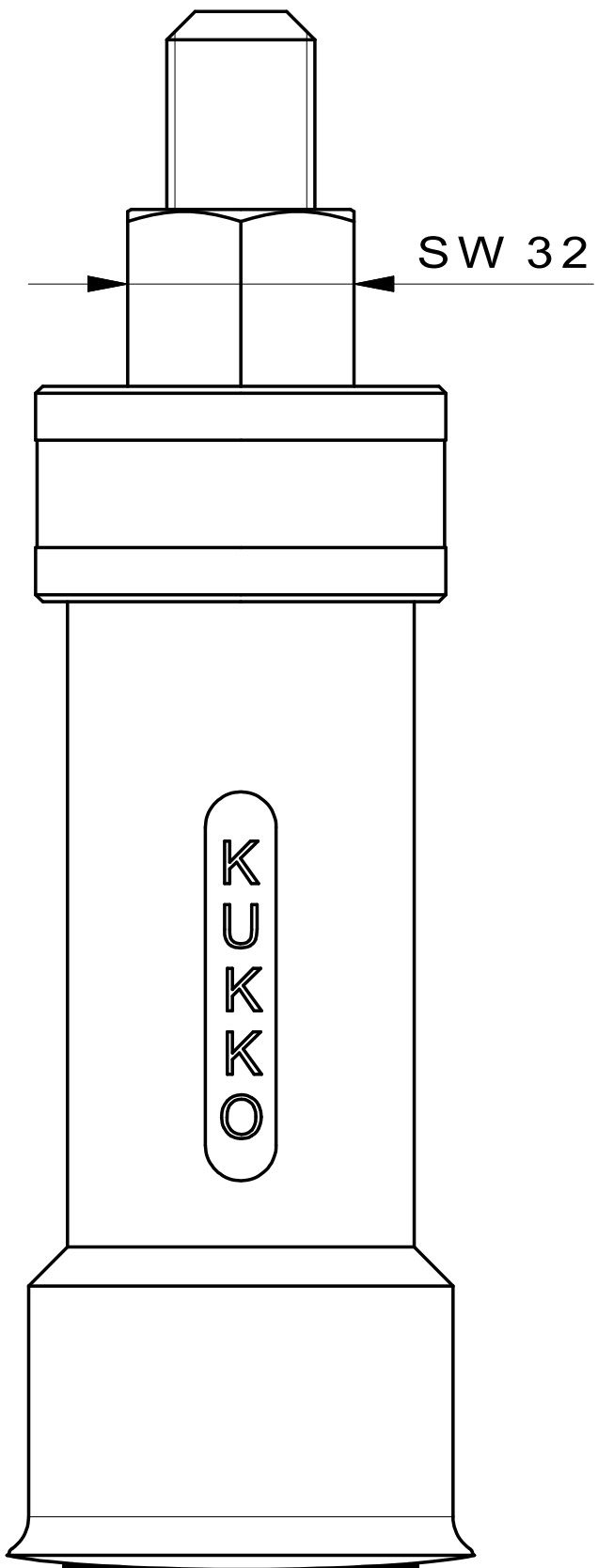
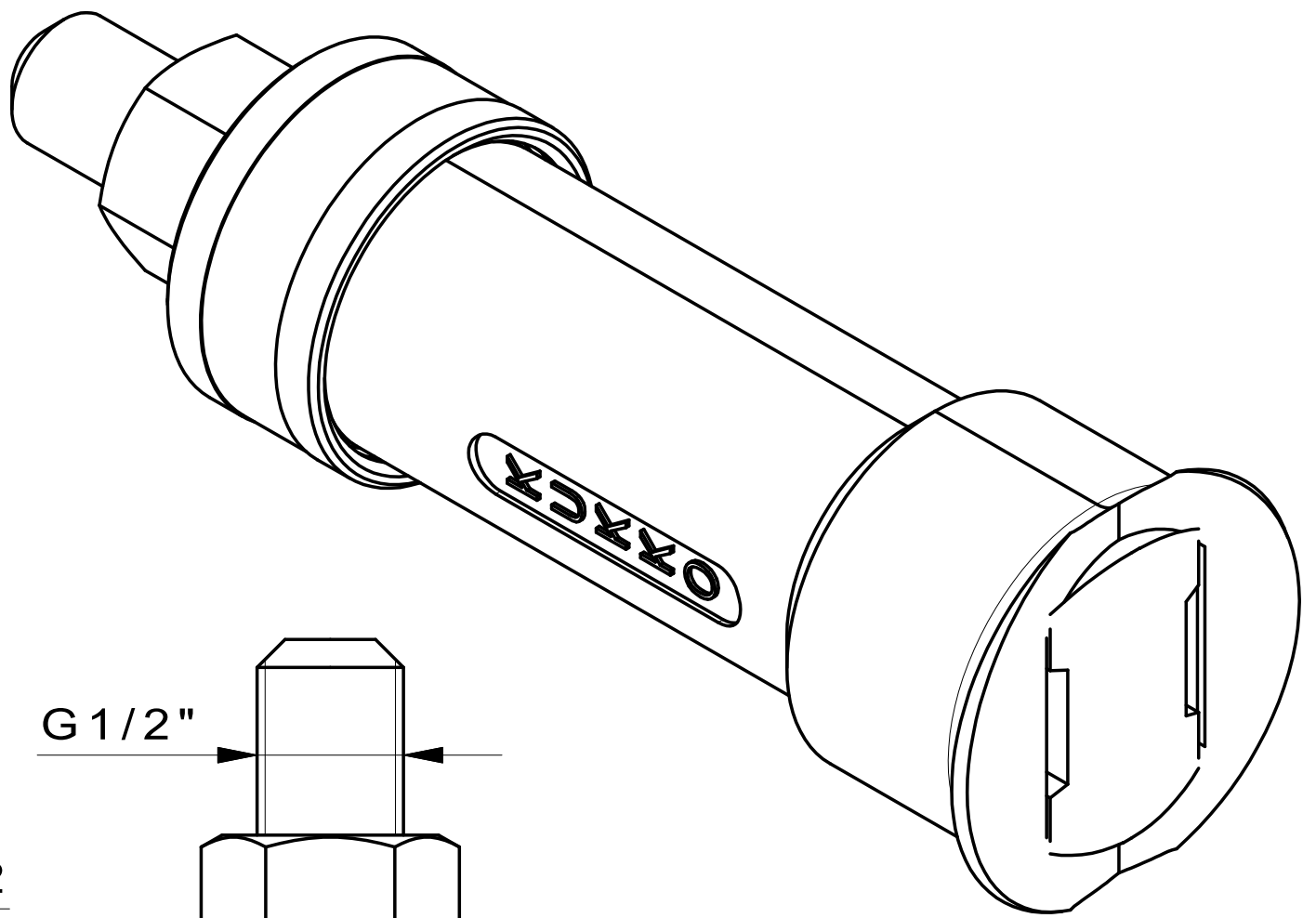
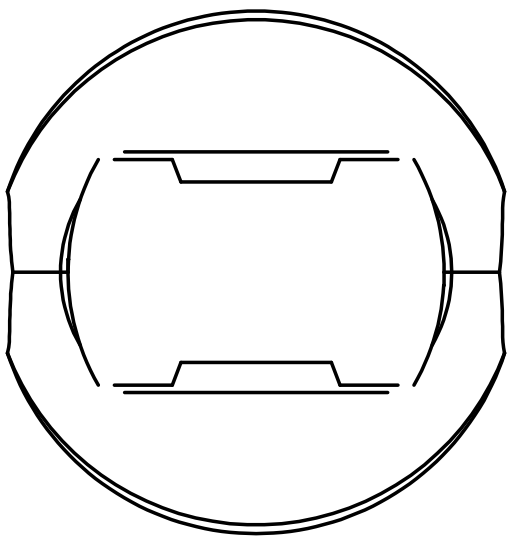

| | | | |
|---|--------------------------------------|--|---|
|  Kleinbongartz & Kaiser oHG Werkzeugfabrik Hilden - Germany | Dokumentname: 21-9 Innenauszieher | | Toleranz: DIN ISO 2768-m |
| | Dokumentbeschreibung: ZSB | | Material: Hochfester extra zäher Vergütungsstahl/ High tensile strength and toughness steel |
| | Erstellt / Geprüft von: Schultes | Erstellungsdatum: 05/06/2015 | Maßstab: 1:1 |
| Teilbeschreibung: Innenauszieher/ Internal extractor | | Wärmebehandlung / Härte: vergüteter Stahl/ tempered steel | |
| | | Oberflächenbehandlung: | |
| Artikelnummer / ZNR.: 21-9 | Dokumentversion: - | Schutzvermerk ISO 16016 beachten | |