

22-0-05 Sliding hammer device with 0.5 kg impact weight



DESCRIPTION

Series 22-0 slide hammer devices are used together with series 21 internal extractors in trade, industry and workshops. The use of a slide hammer is particularly recommended when there is no support surface or it is too sensitive. The ergonomically shaped, solid slide piece enables the applied force to be optimally transmitted and a strong shock effect to be achieved. This also ensures contact-free and gentle extraction. Sliding hammers are available in various sizes and accessories with impact masses from 500 g to 8 kg for every application.

RANGE OF APPLICATION

Together with internal extractors of the series 21

BENEFIT

- The shape of the sliding piece enables a high impact weight of the slide hammer with easy application
- The internal stop point prevents crushing and ensures a safe working process
- If there is not enough space, the impact weight can be turned round

OPERATION

- Determine the internal diameter of the ball bearing and select a suitable internal extractor
- Insert the internal extractor into the bore and tighten the clamping nut
- Screw the slide hammer rod onto the wedge spindle of the internal extractor
- Use the slide hammer with a percussive motion to pull out the bearing

MASTER DATA

GTIN [EAN]	4021176283697
Country of origin	DE
Case material	Tool steel
Series	22-0
Net weight [kg]	0,85 kg
Package contents	1 piece
Packaging Act	

APPLICATION IMAGE



DETAIL IMAGE



Sliding hammer device with 0.5 kg impact weight

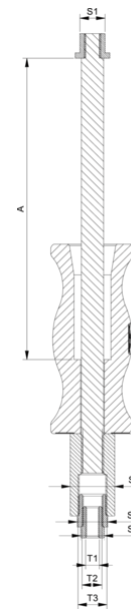
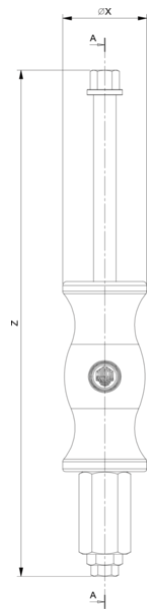

Abbreviation	Attribut	Wert
X	Diameter [mm]	40 mm
S2	Width across flats Thread adapter [mm]	12 mm
S1	Width across flats stop nut [mm]	19 mm
T2	Internal thread of the thread adapter [nominal dimension]	M7
T3	Internal thread of the connecting nut [nominal dimension]	M10
A	Impact distance [mm]	200 mm
S1	Width across flats connecting nut [mm]	19 mm

Abbreviation	Attribut	Wert
X	Diameter [mm]	40 mm
S2	Width across flats Thread adapter [mm]	12 mm
S1	Width across flats stop nut [mm]	19 mm
T2	Internal thread of the thread adapter [nominal dimension]	M7
T3	Internal thread of the connecting nut [nominal dimension]	M10
A	Impact distance [mm]	200 mm
S1	Width across flats connecting nut [mm]	19 mm

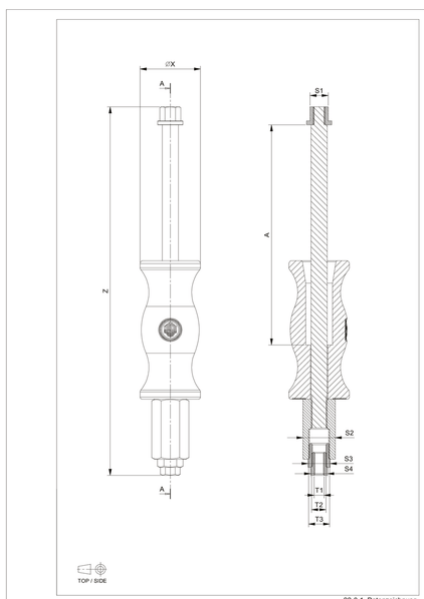

Abbreviation	Attribut	Wert
--------------	----------	------

X	Diameter [mm]	40 mm
S2	Width across flats Thread adapter [mm]	12 mm
S1	Width across flats stop nut [mm]	19 mm
T2	Internal thread of the thread adapter [nominal dimension]	M7
T3	Internal thread of the connecting nut [nominal dimension]	M10
A	Impact distance [mm]	200 mm
S1	Width across flats connecting nut [mm]	19 mm